

ALTERNATORS

A93/90A

Wound field alternator
13.5 V - 90 A

Description

A compact alternator for sport cars.

Rewound stator with flexible connections to bridge.

Upgraded and ruggedized rectifier bridge to deal with extra power and harsh vibrational environment.

Sealed high speed & quality bearings.

Stiffer brush springs for harsh vibrational environment.

Brackets modified to prevent stator rotation.

The rear bracket can be supplied as shown or rotated by increments of 90°.*

Connection by spade connector or dedicated loom.*

* Contact factory for these options.



Main Features

- 90 A output
- 18000 rpm max speed
- Clockwise rotation
- 2.6 Kg weight

Benefits

- High output to weight ratio
- Integral voltage regulator

Typical Applications

Touring car

Rally car

Typical Performance

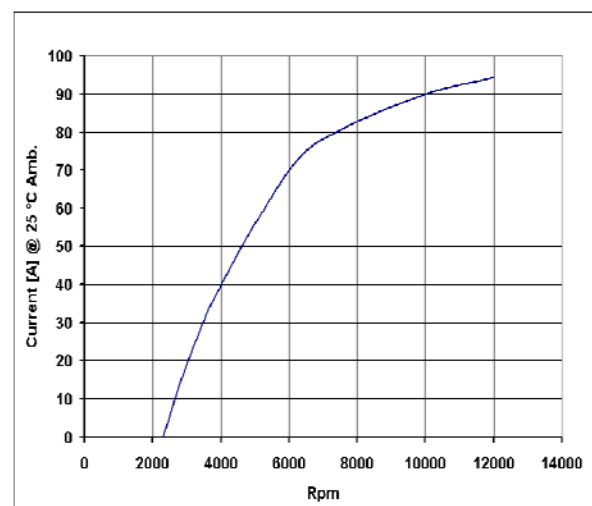

ALTERNATORS

A93/90A

Wound field alternator
13.5 V - 90 A

Dimensions

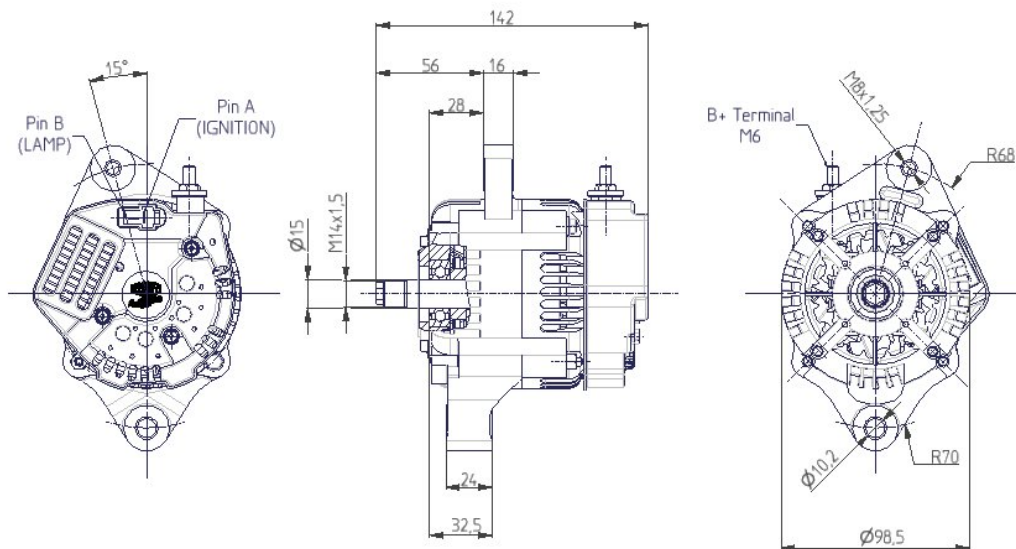

Dimensions in millimetres

Technical Characteristics

Cut in speed.....	2400	rpm
Maximum speed.....	18000	rpm
Rotation.....	Clockwise only	
Operating temperature (ambient).....	Up to 90	°C
Regulated voltage.....	13.5	V
Weight.....	2.6	Kg

Application Schematics

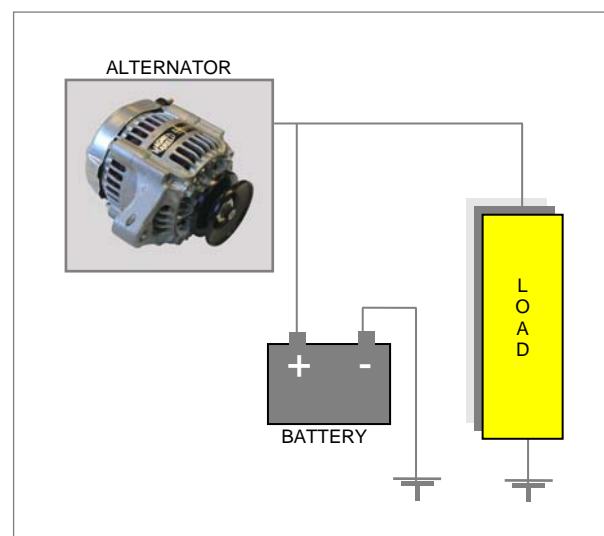

For further information, please contact:

A93/90A-050370431000



Magneti Marelli S.p.A.
Motorsport
Viale Aldo Borletti, 61/63
20011 Corbetta (Milano) Italy

Tel. +39 02 972 27 478
Fax +39 02 972 27 570
sales@magnetimarelli.com
http://www.magnetimarelli.com

February 2010
rel. 08
page 2 of 2