

## XKP1290 CABLE

1 MPa pressure sensor

### Description

---

Gauge amplified pressure sensor.

Particularly suited for use in the harsh automotive environment.

### Main Features

---

- Compatible with most fluids in automotive environment
- Fast response time

### Benefits

---

- Small size
- High output
- High reliability



### Typical Applications

---

Oil pressure

Fuel pressure

# XKP1290 CABLE

1 MPa pressure sensor

## Technical Characteristics

Power supply .....	8 to 30	V
Supply current.....	< 20	mA
Null offset.....	0.5	V
Full scale output (@ Nominal Pressure).....	4.5	V
Nominal pressure.....	1	MPa
Operating temperature range.....	-40 to 140	°C
Response time.....	< 2	ms
Accuracy (f.s.o. and Null offset)		
@ -40 °C to 0 °C.....	max. ± 2.5	% f.s.o.
@ 0 °C to 90 °C.....	max. ± 1	% f.s.o.
@ 90 °C to 125 °C.....	max. ± 3	% f.s.o.
Burst Pressure .....	3 x Nominal Pressure	
Vibrations range tested		
@ 147 Hz to 1000 Hz.....	30	g
@ 1000 Hz to 2000 Hz.....	20	g
Protection class.....	IP 67	
Weight (approx.) .....	50	g

## Dimensions

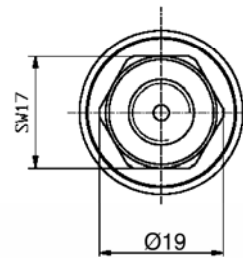

Red: Supply voltage  
Green: Signal  
Blue: GND

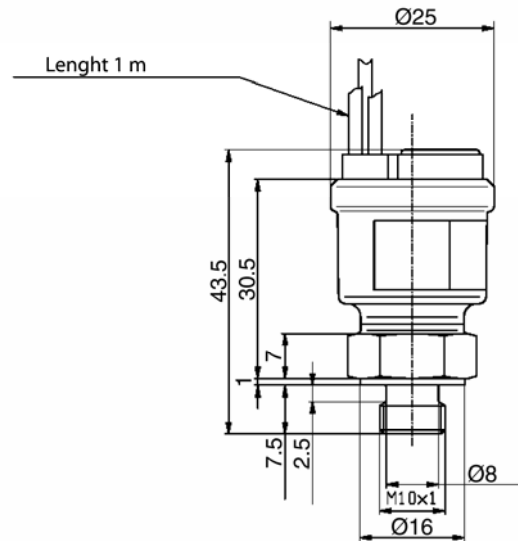

Dimensions in millimetres

For further information, please contact:

 **Magneti Marelli Holding S.p.A.**  
Motorsport  
Viale Aldo Borletti, 61/63  
20011 Corbetta (Milano) Italy

Tel. +39 02 972 27 478  
Fax +39 02 972 27 570  
sales@magnetimarelli.com  
http://www.magnetimarelli.com

November 2007  
rel. 03  
page 2 of 2